



Value Added Distributor

QTech Distribution

Focus on solutions in the AV/IT/UC space.

Products/ Solutions in:-

- Streaming & recording
- Digital whiteboards
- Capture Cards
- Network switches
- Control and automation
- Wireless Presentation System
- Video wall controllers (Software)
- Digital Signage Solutions (CMS) + Media Player

Sole Authorized Distributors for Niche International brands

 epiphan video NOW **SIGNAGE** 

OUR CUSTOMERS



FlintGroup

H'AFELE

Walmart*



HubSpot

Goldman
Sachs



SPACEPORT AMERICA

Deloitte.

indeed®

PHILIPS

HBO®

P&G

G A P

pwc

ERICSON®
Since 1918

 **Manchester**
University

GENERAL
DYNAMICS

 THE UNIVERSITY
OF ARIZONA



PEPSICO

and many more



Recording and Streaming



Capture Cards

Multiple Award Winning Product



Specific variants with multi-purpose, all controlled easily via Epiphan cloud



Pearl Nano

Ideal for small-scale productions, SRT contribution encoding, and as a streamer/recorder add-on to an existing setup.



Pearl Mini

Offers the all-in-one functionality of Pearl-2 in a more portable chassis with a giant touch screen for maximum ease of use.



Pearl-2

Brings the pro features and processing horsepower required for the most demanding video production use cases.*



Monitor and control events in the cloud

Epiphan Cloud lets you conveniently review scheduled Panopto events, check the status of integrated encoders, and start, stop, pause, or add time to ongoing events.

epiphan.com/cloud

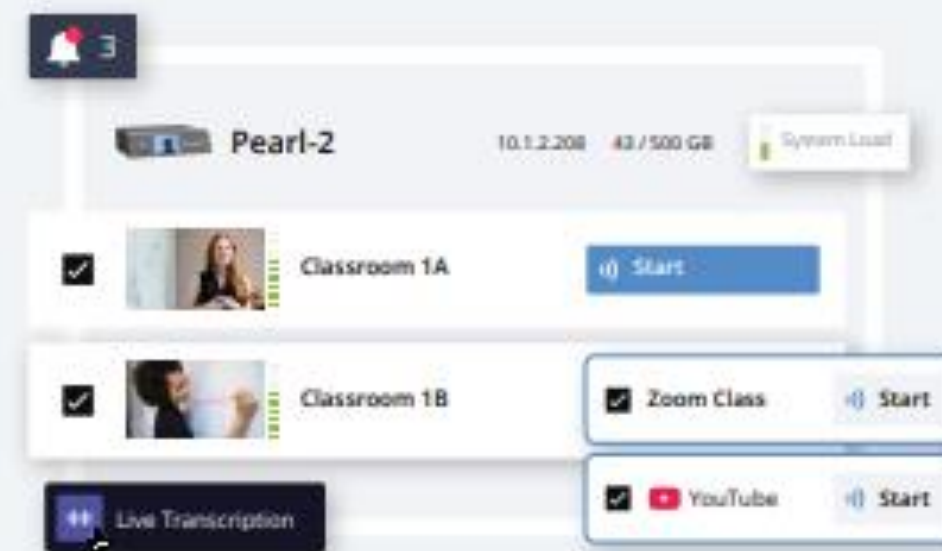

Applications:-

Live Production



Supports A/V companies providing event services to conferences, corporations, venues

Education



Lecture capture and global streaming, library archive and access, streaming and recording of campus events

Corporate



Corporate seminars, training, product demonstrations, conferences & town halls, outreach and social networks

UX Labs

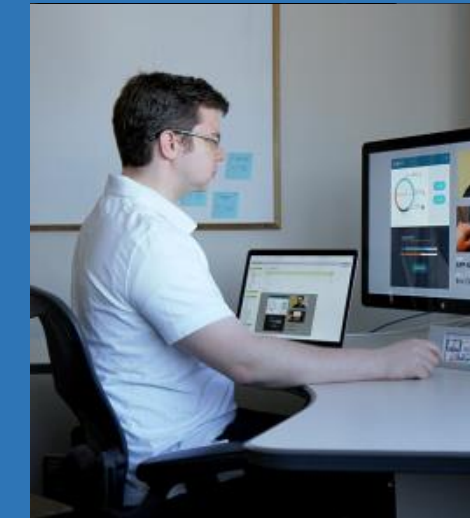

Record and live stream user experience and focus group trials enabling remote participation of developers

House of Worship



Streaming ceremonies and services of churches and other religious groups



Pearl 2 Rack mount



Pearl Mini



Pearl Nano

Video inputs	2 × 4K HDMI, 2 × HDMI, 2 × 12G SDI 2 × USB	2 × HDMI, 1 × 3G SDI, 2 × USB	1 × 4K HDMI, 1 × 12G SDI
Audio inputs	4 × XLR, 1 × RCA (stereo pair)	2 × XLR/TRS, 1 × 3.5mm, 1 × RCA (stereo pair)	2 × XLR, 1 × USB 1 × RCA (stereo pair)
Networked inputs	SRT, NDI, NDI HX, RTSP	SRT, RTSP, NDI HX	SRT, RTSP
Video outputs	2 × HDMI	1 × HDMI	1 × HDMI 1 × HDMI (pass through)
Chroma key	Yes	No	No
Power	DC	DC	PoE+ or DC
Storage	512 GB SSD	SD card (user supplied)	SD card (user supplied) SATA M.2 SSD (user supplied)
Resolution	Upto 2160p(4K requires additional license)	Upto 1080p(Full HD)	Upto 2160p(4K requires additional license)

Epiphan Video

Audio/Video Capture Cards



	<u>AV.io 4K</u>	<u>AV.io HD+</u>	<u>AV.io SDI+</u>
Resolution support	Up to 2160 (4K)	Up to 1080p (Full HD)	Up to 1080p (Full HD)
Interface	USB 3.0, USB 2.0	USB 3.0, USB 2.0	USB 3.0, USB 2.0
Inputs	HDMI (including audio)	HDMI (including audio), 3.5 mm analog (audio)	3G-SDI, HD-SDI, SD-SDI (including embedded audio for 3G-SDI and HD-SDI), 3.5 mm analog (audio)
Output frame rate	60 fps 1080p, 30 fps 4K	60 fps 1080p	60 fps 1080p
Audio support	HDMI	HDMI, Stereo 3.5 mm	SDI, 3.5mm audio
Works with third-party encoder software	Yes	Yes	Yes
Driverless (UVC)	Yes	Yes	Yes
Automatic image scaling and audio resampling	Yes	Yes	Yes
USB powered	Yes	Yes	Yes
Compression	Uncompressed video capture	Uncompressed video capture	Uncompressed video capture

Kaptivo- Whiteboard Digitization

Digitize your existing whiteboard for secure saving and sharing online or in video conferencing and lecture capture systems.

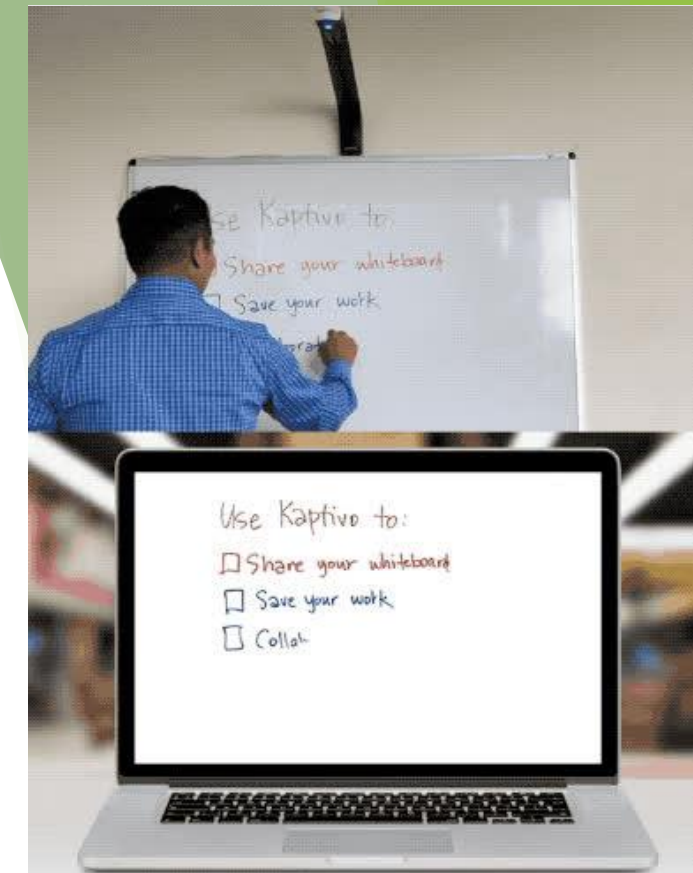

Kaptivo- Whiteboard Digitization

Digitize your existing whiteboard for secure saving and sharing online or in video conferencing and lecture capture systems.



Kaptivo Rooms Enterprise

Kaptivo

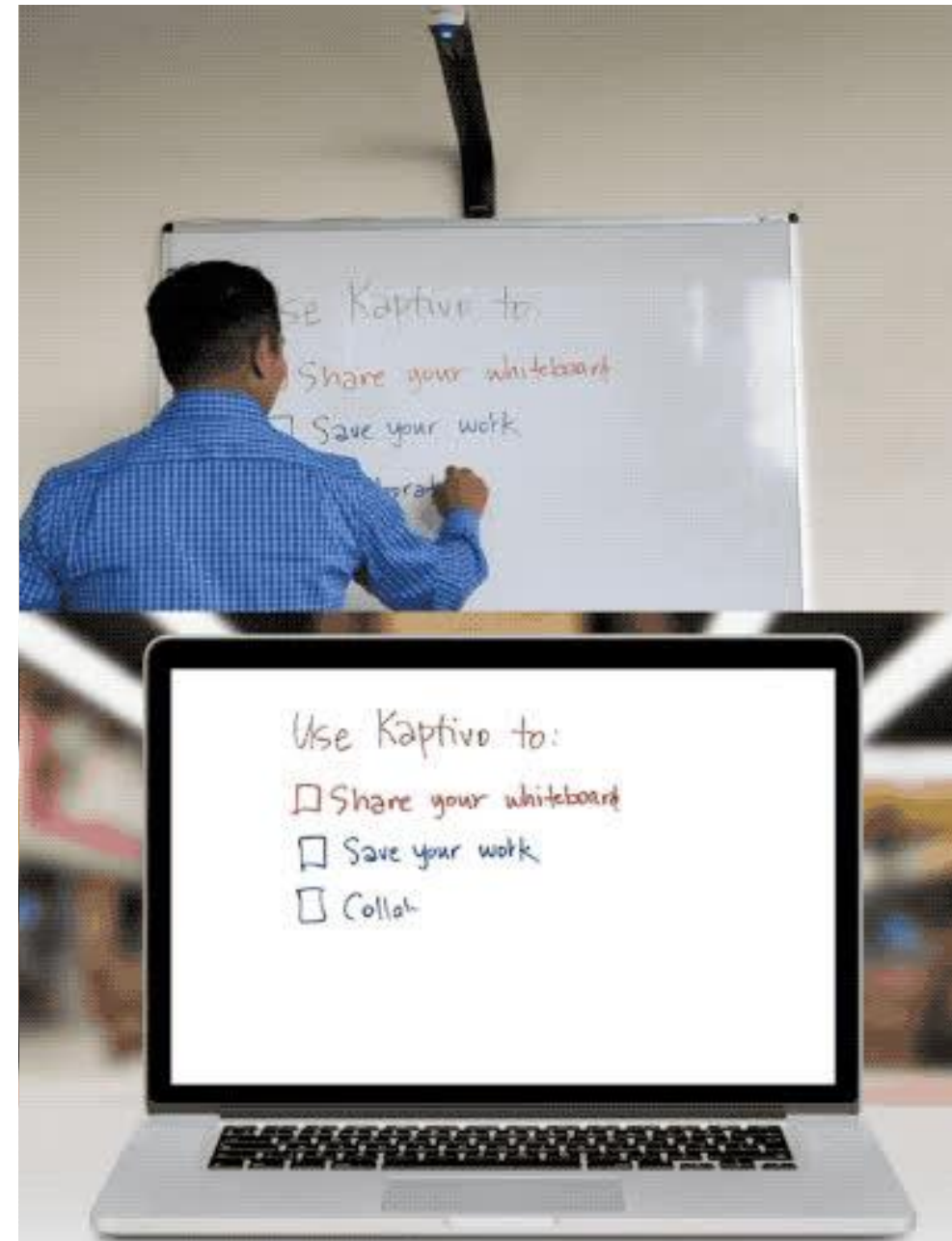

LOCAL HOST MODE

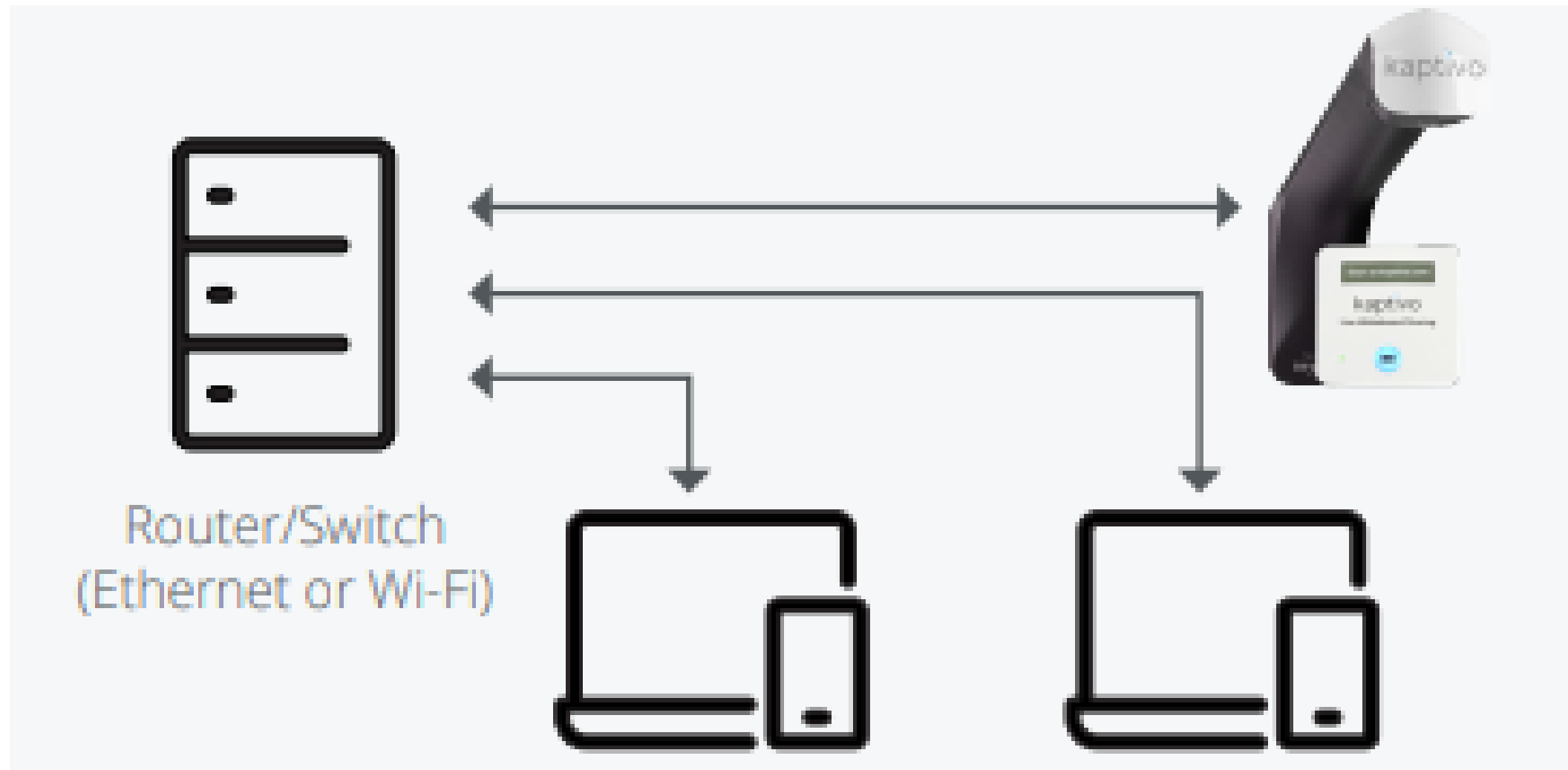

Local Host mode allows you to connect directly to the Kaptivo device via your local network, enabling seamless integration with your existing infrastructure and simplifying setup and operation.

With Local Host mode, you have the flexibility to deploy Kaptivo in a wide range of environments, from conference rooms to training facilities, without the need for additional hardware/software.

Kaptivo on Campus

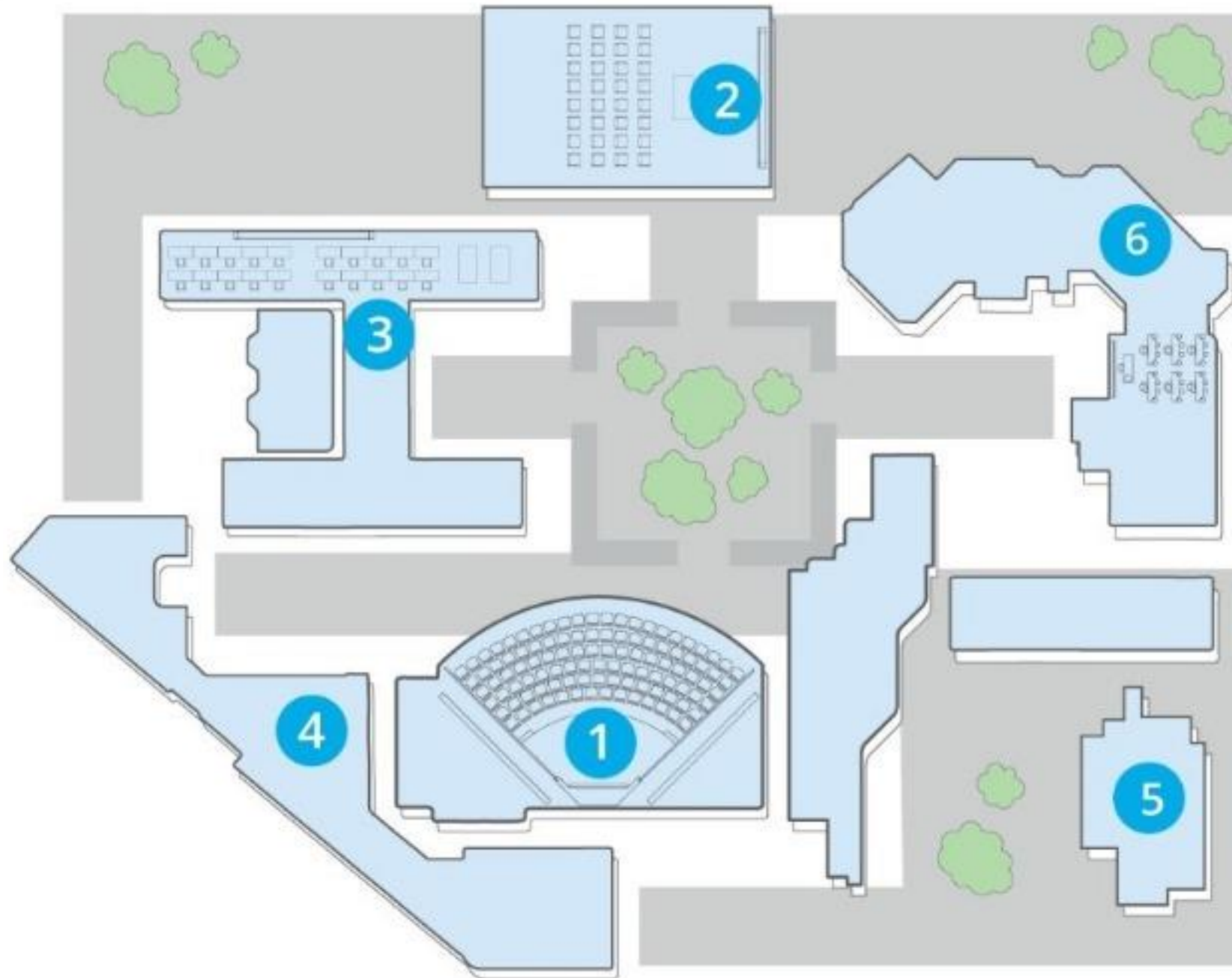

- 1. Auditorium
- 2. Classroom
- 3. Active Learning room
- 4. Distance Learning
- 5. Conference/ Meeting Room
- 6. Research Area/Lab

Kaptivo in a Corporate Setup

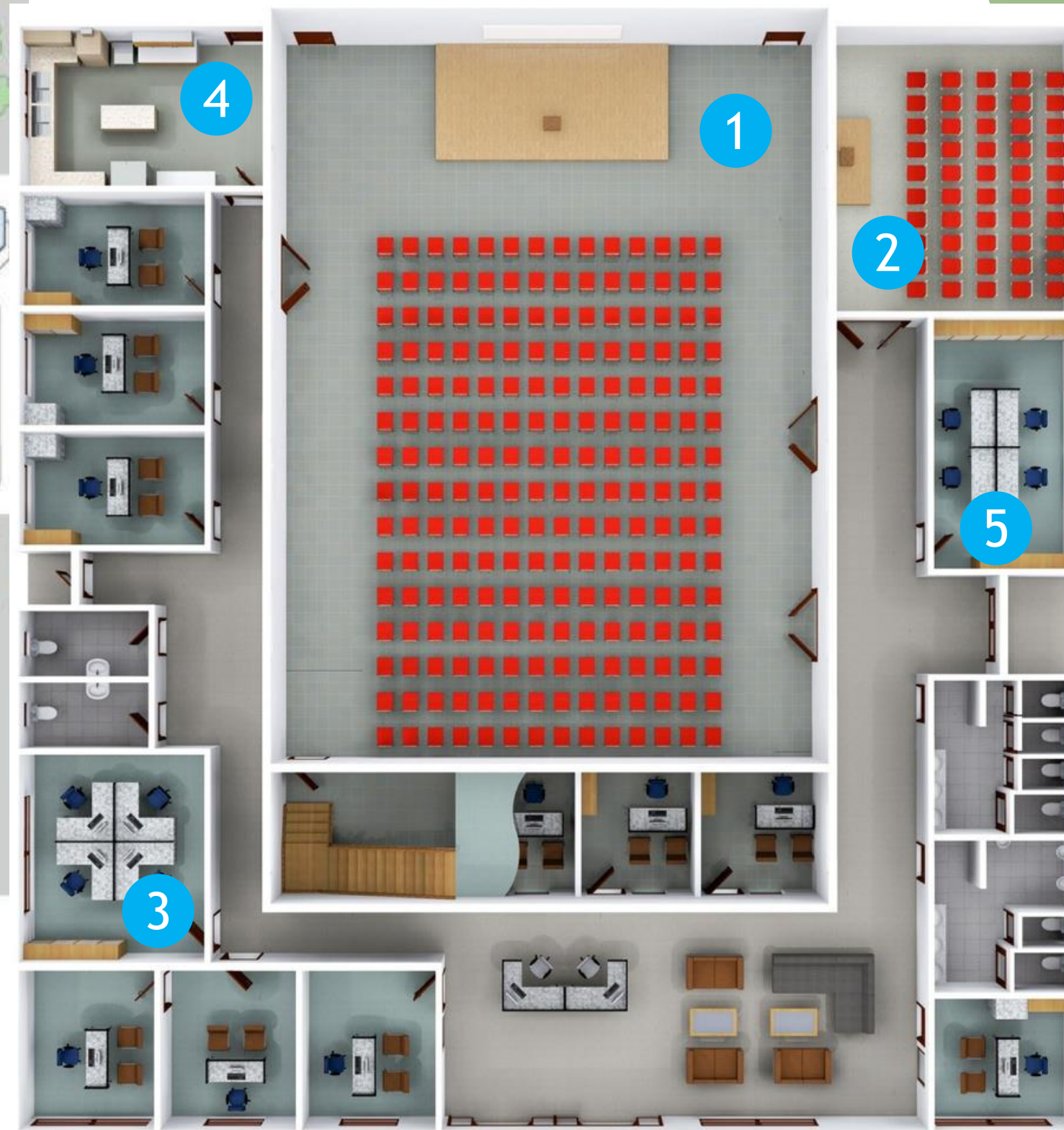

- 1. Auditorium
- 2. Training room
- 3. Board room
- 4. Research Area/Lab
- 5. Conference/ Meeting Room

Customers:-

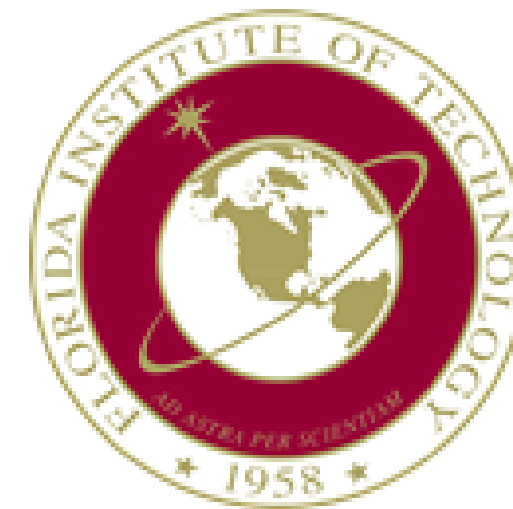

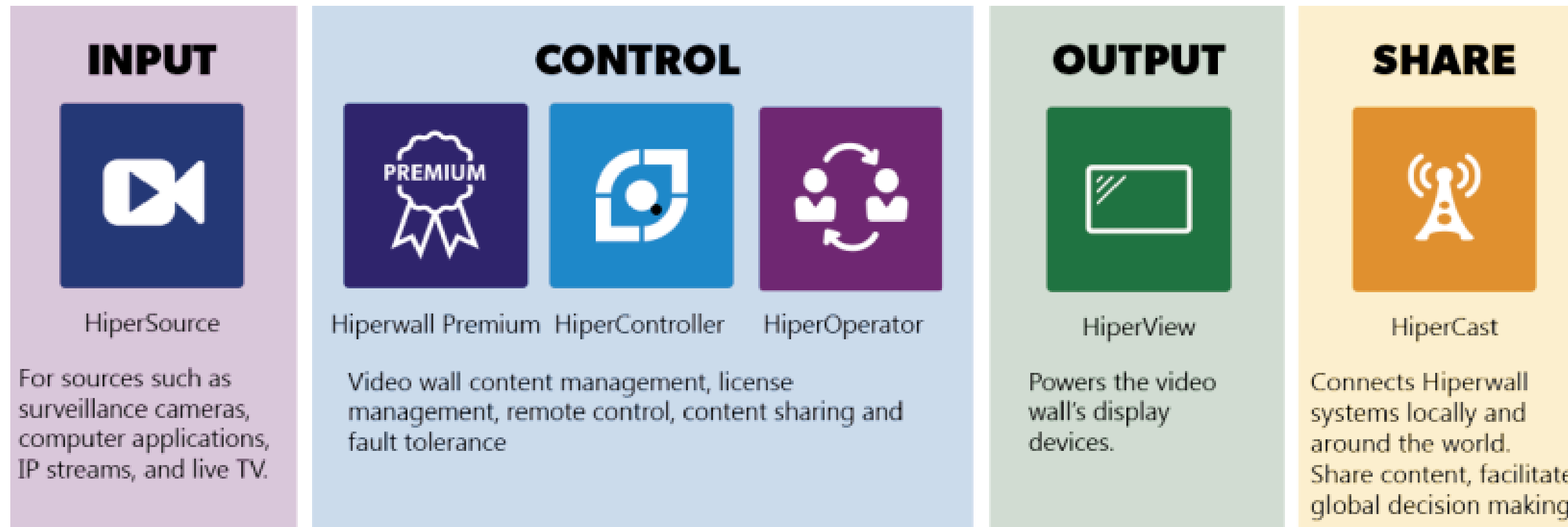

- 100% software-based video wall system using AV-over-IP and distributed visualization for scalability, flexibility, and cost-efficiency, enabling seamless content sharing across multiple displays and locations.
- First to market with AV-over-IP infrastructure
- 4,000+ installations across 71+ countries
- Multiple patents in video wall and AV technology
- Global channel partner network
- New features added annually
- Made in America – engineered and manufactured in the USA

Key Benefits of Hiperwall Video Wall Solutions

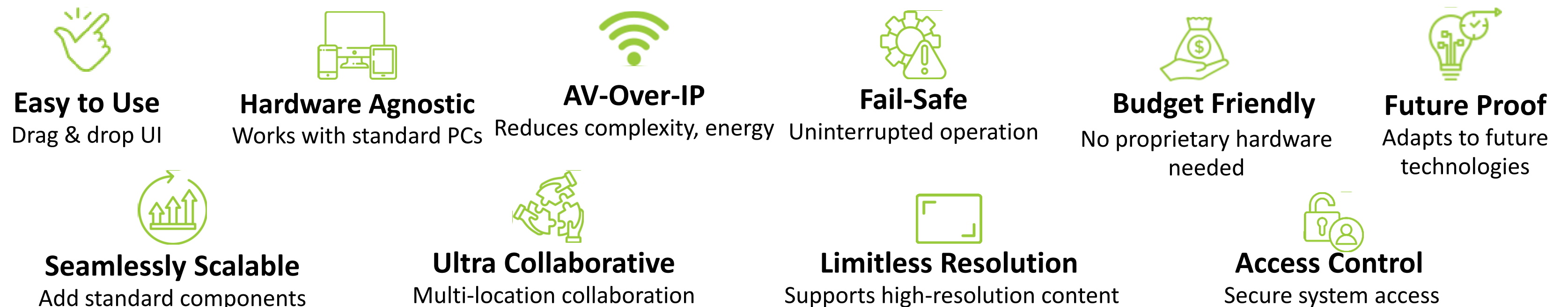

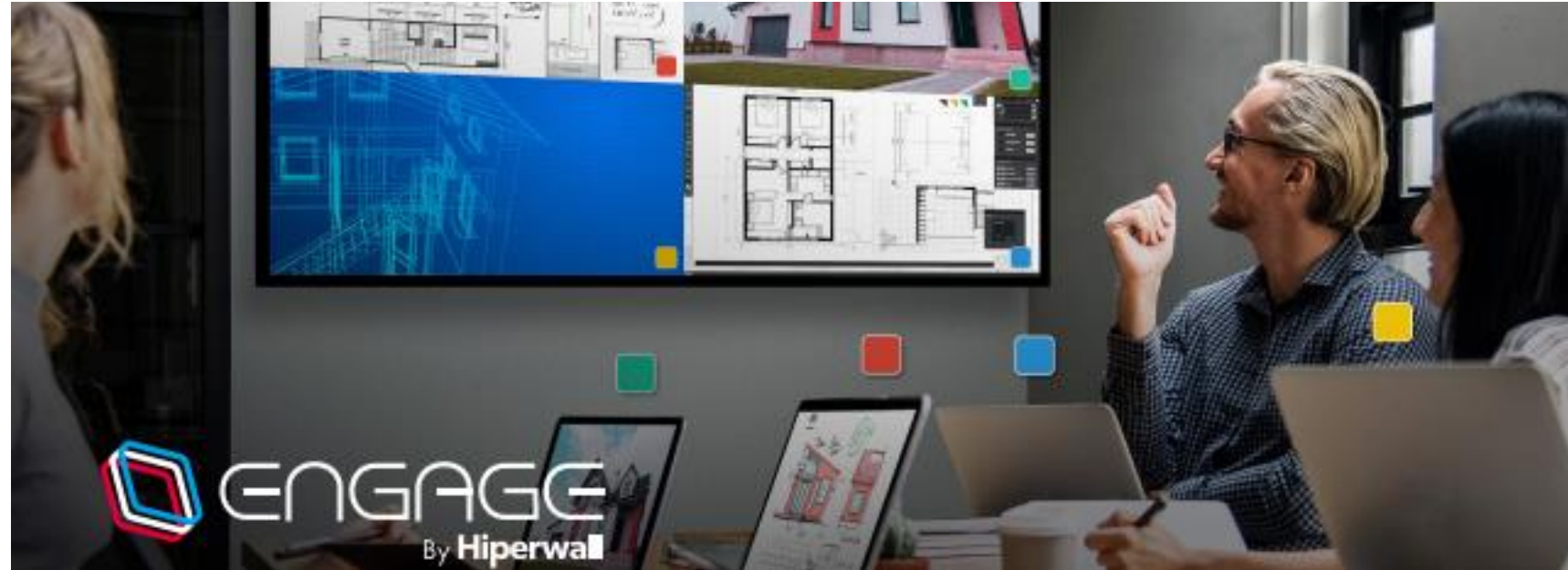

Engage is a collaboration solution that promotes productive meetings among peers both in the office and working remote.

Ideal for Huddle rooms, Conference Rooms, Classrooms, Boardrooms, and more

Works with Zoom, Teams and popular VC platforms

SIMPLE

- No logins and passwords to remember
- Open canvas up in your browser
- No complicated UI learning curve

SEAMLESS

- No wires or dongles to plug in
- Up to six content pieces can be shared
- Engage can be shared to any VC app

SECURE

- Advanced end-to-end data encryption
- No app or document data is being shared, just pixels
- Built-in security features to mute, kick out, and even block users



A STREAMLINED, ON-PREM SOLUTION: FOR SMALL OPERATIONS CENTERS

Engage Ops delivers the essential capabilities of a command center in a streamlined, software-driven solution. Ideal for small organizations, satellite offices, or tactical teams looking to visualize and act on real-time data from a single display.



- Run on a single PC – no cloud, no AV stack.
- Share up to 6 live streams with 12 operators.
- Mask sensitive content, disable in-room display for privacy.
- Stream to overflow rooms securely.
- Includes 2 years certificate mgmt + 2 major updates.
- Supports remote setup help & certified PC recommendations.
- Ideal for emergency coordination, security and surveillance, utility and infrastructure, logistics.

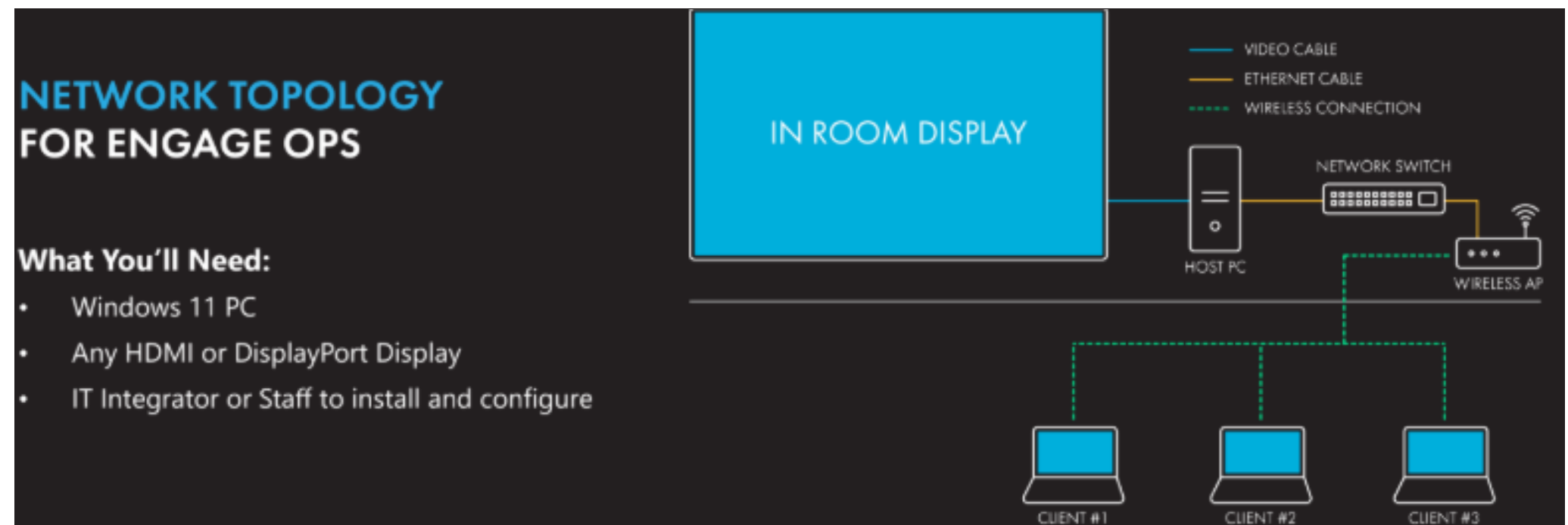



APPLICATIONS & USE CASES

Command and Control

Acquire visual intelligence, make informed decisions, enhance group collaboration, keep executives informed and receive important alerts.

"We use Hiperwall to display our outage map, track vehicle locations, check the weather radar and obtain security camera feeds of video in and around our facility."

-- Wayne Odom, IT Administrator at Four County EMC.

Digital Signage

Create a video wall as large as you choose (unlimited scalability), attract attention with a large-scale display, impress with unlimited pixel resolution and easily change content.

"Visitors remark on the beauty of the presentation, its visual impact, and the emotional connection that is created between the visitor and the stories presented on the video."

-- Melanie Poole, Communications Officer with the American Village Citizenship Trust.

Entertainment

Engage, inform and entertain an audience, make the technology a part of the experience.

"Hiperwall gives our creative team state-of-the-art digital content capabilities like no other solution available on the market."

-- Blue Man Group

Corporate AV

Communicate important information, messages and updates, promote your brand, easily change content, distribute information throughout a facility, and send key information to executives.

"The main goal for the wall was to serve as this visually striking, dynamic centerpiece in the lobby for clients, partners who come and visit, and internal employees as well. The images are so bright and vivid that it is really a striking presentation as soon as you walk in the lobby. I do believe our goals for the wall have been accomplished."

-- Todd Spencer, T3's Enterprise Architecture Supervisor.

Education

Enhance the educational experience, facilitate collaborative learning, update content quickly, improve communication with students and visitors, and create a larger display for a big class to see.

"It has revolutionized my course—not just how I teach, but what I teach as well. Using the Collaborative Digital Learning Lab (CDLL), my students are interacting, solving problems and visualizing chemistry in a way I haven't been able to attempt before."

-- Dr. Nate Brandstater, Associate Professor of Chemistry, La Sierra University.

TRUSTED BY INDUSTRY LEADERS



Enterprise Video and Digital Signage



Reliable media players and software tools for the delivery of high quality audio, video, and graphics in commercial settings.

We collaborate with system integrators and technology partners to offer solutions that are both easy to deploy and use.



Applications:-



Government and Military

Amino devices have been in the “room where it happens” enabling real-time viewing of aerial reconnaissance and security operations



Residential

Our media players are behind the screens, delivering entertainment content to residents of hospitals, universities and prisons in both common and private areas



Corporate Video

Amino facilitates in-house video delivery and consumption for screens in common areas, lobbies and meeting rooms



Hospitality

Amino devices with PoE simplify installation in hotels rooms around the globe



Stadiums

Our media players make sure fans don't miss a second of the event with high quality video and graphics distributed to screens throughout the stadium



Point-of-Sale and information Services

Amino media players power video and advertisement services at PoS counters and kiosks; and provide real-time information within transportation hubs

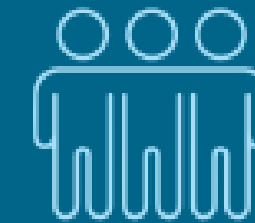

Community Portals

Amino solutions connect communities to the content they need, whether on oil rigs, at the south pole, in the doctor's office or on a cruise ship or aircraft

Front View



Back View



Accessories

- | | | | |
|--------------------------|-----------------|-------------------|--------------------|
| 1 IR Receiver Panel | 5 A/V Out | 9 2x USB | 13 Power Supply |
| 2 Ethernet (PoE) | 6 IR Extender * | 10 Power 12V/1A | 14 HDMI Cable |
| 3 Serial I/O port | 7 HDMI | 11 VESA Mount | 15 IR Extender ** |
| 4 Digital Audio (S/PDIF) | 8 Reset button | 12 Remote Control | 16 Wi-Fi Dongle ** |

*For out of sight deployments **Optional accessories



Cloud Based System for Effortless Device Management:-



Benefits:



Reduce time
to resolution



Centralized device
management and
software updates



Protect your
brand reputation

Key features include



Web-based graphical user
interface to control and manage
deployed devices.



Remotely view and control connected
media players enabling quick and
definitive problem resolution.



View connectivity and performance
diagnostic data about issues
impacting QoS or QoE.



Manage and schedule firmware
and application updates.

Partnerships :-



Customers:-

25+ Years | 100+ Countries

We deploy our products and solutions in countries around the globe.
Our customers include:



Digital Signage Software for ANY screen, ANYWHERE

- NowSignage is a multi-award-winning cloud-based Digital Signage CMS crafted with unique simplicity, flexibility and scalability.
- Manage and Schedule your digital signage board's content with ease using our CMS.



WINNER

AV AWARDS
2021, 2022, & 2023

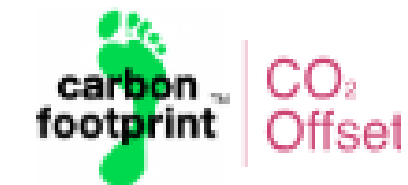

Hardware agnostic

Hardware-agnostic through a single codebase, you can therefore rest assured that whatever hardware, media player or SoC, NowSignage will just work.



NOWSIGNAGE

Easy to use

Possibly the easiest to use CMS anywhere in the world today, which means that any end-user can be fully trained and competent on NowSignage within just 30 minutes.

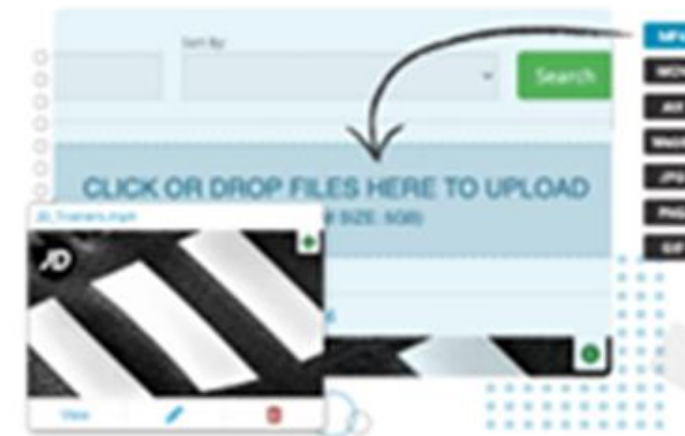

Most affordable

True SaaS, all users, are granted access to the exact same features and functionality at no extra cost. Our aim is to develop and maintain the best CMS on the market.



Custom integrations

Industry leaders in achieving award-winning direct integrations with 3rd party softwares. When we develop an integration, we do it properly with a full API integration.

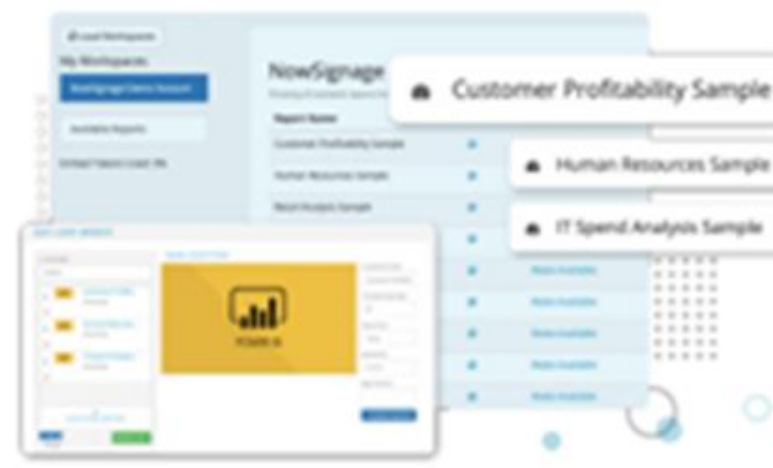

Applications in different sectors:-

Features and Benefits

- ▶ Utilise touchscreen devices with Room Bookings
- ▶ Show off offers by scheduling product advertisements
- ▶ Broadcast announcements to guests on your screens instantly
- ▶ Use multi zone layouts to maximise your displays
- ▶ Engage your internal team with back of house comms

▶ Live Events

▶ Hospitality

Features and Benefits

- ▶ Display sponsors logos and advertisements at events
- ▶ Integrate social media to show user-generated content
- ▶ Use content triggers to adapt to weather changes
- ▶ Control overcrowding with capacity management
- ▶ Increase revenue with dynamic pricing at food and drink outlets

Features and Benefits

- ▶ Educate patients in waiting areas with treatment options
- ▶ Navigate around by displaying interactive directions
- ▶ Display waiting times and queue information
- ▶ Utilise content triggers to promote targeted health information
- ▶ Use OnDemand to display announcements from a mobile device

▶ Healthcare

▶ Education

Features and Benefits

- ▶ Showcase student work by scheduling different projects
- ▶ Display announcements across large networks of screens
- ▶ Display live IPTV channels across campus common areas
- ▶ Utilise touch screen displays for interactive maps and wayfinding



Activate Microsoft Power BI

NowSignage is the only CMS to have developed a full integration with Microsoft Azure, so that Power BI users can display BI reports, dashboards, and other data, completely privately and securely. Within a corporate environment, it is imperative to cut through the noise and succinctly present business critical information to a relevant audience at a time and place that allows them to make informed decisions.

Share Social Media

To keep your audience engaged and prevent them from tuning-out, it is essential that you keep your content targeted and relevant to them. By creating automated RSS feeds and social media walls, your teams can be kept abreast of internal and external news that's specific and relevant to them, ensuring your people stay informed and remain engaged.



Digital Menu Boards

Used in QSR (quick-serve-restaurants), hotels and bars our unique solution for digital menu boards provides the flexibility to sync content playback across groups of screens running via SoC or media players. When choosing software for your digital menu boards, NowSignage is an easy decision due to the ability to make changes to your screen pricing and promotional content "on the fly".

Customers and reviews:-

“



Being able to update content through a Web-based dashboard means we're able to update all our campus screens with content much more regularly and can react to information needs as they arise. I can now pre-schedule loops of content to play depending on my audience.

University of Oxford

“



The most advanced, secure and cost effective CMS on the market.

The Coca-Cola Company

”

“



When seeking out a CMS to aid our digital signage transformation programme we had some key requirements; the ability to have multiple levels of access & permissions, be extremely easy and intuitive so that new users can get up to speed quickly, and a platform that was value-driven but had all the premium features we required. NowSignage excelled in all of these areas and had a team with experience and knowledge to guide us through the whole process.

Pennine Care NHS Foundation Trust

“



NowSignage are a lot more than a digital signage software, they also provide great support whenever we need it. Their easy to use platform allows us to deliver dynamic room pricing, drive footfall into our bars, and even equips us with free apps to ensure we comply with COVID legislations.

DoubleTree by Hilton

”

Customers in various sectors:-

FOODWELL



DECATHLON

P&G

Coca-Cola



Senex 

 Netigate

Choose Niveo, where excellence meets simplicity. Best in class AV-switches in 1G, 10G and AVB supporting all Video-over-IP (Incl SDVoE) and Audio-over-IP protocols (Dante, AES67, Ravenna), outshining others with easier installation, best installer support and competitive pricing.

Enterprise Grade Switches:-



NGSME9AVB
9-PORT AVB POE+ SWITCH



NGSME48T4HX
48-P 10/100/1000 Base-T + 4 10G Combo
TP/SFP Layer 2/3 + PoE+ Switch(2*920 W) Dual
Power

10G Switches:-



N10GSM24XP
Full L3 Managed 10G SFP+
SDVoE-ready Switches



N10GSM6QF48
48 x SFP+ & 6x40GbE QSFP+ switch

Wireless:-



Wi-Fi 6 access points and controllers.
Excellent speed and efficiency
– by NIVEO

Why use Niveo Professional Switches?



PoE+ Scheduling
Self Healing PoE+

Video-over-IP:

AV Protocols:



AVB/MiLAN Switch:- (Latest Product)

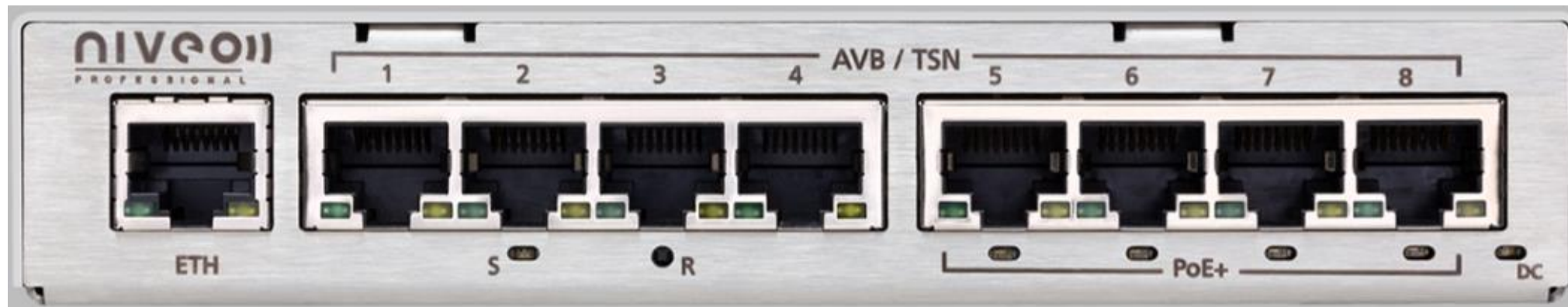

NGSME9AVB switch

- An AVB switch, preconfigured for AVB, Dante and PoE + out of the box.
- No configuration or difficult firmware uploads are needed.
- Also no payment or activation AVB license fees are required.
- Expandable to 16 AVB-Ports



10G Switches:-

- Based on High-end scalable chipset.
- Supports L3/Data Center/Metro features.
- Ready to deploy in your L3 networks or Data centers networks.



N10GSM24XP

Full L3 Managed 10G SFP+ SDVoE-ready Switches with 40G-QSFP+ /100G – QSFP28 Uplink



N10GSM6QF48

48 x SFP+ & 6x40GbE QSFP+ switch, front-to-rear airflow and dual AC power supplies

Business Switches:-

- Rock solid, fan less design to last in every modern installation.
- Ideal for small commercial and residential integrations.



NRS6GP

4 Port PoE gigabit Switch with 1-Port SFP & 1 Gb Uplink Port(65W)



NRS5FP

4+1 * 10/100 FE port switch with 4p PoE (60W)

Enterprise Grade Switches:-



- Wide range of configurations for audio/video, security and broadcast integrations.
- Chipsets made by US Chip manufacturers for industrial and enterprise application.

NGSM48T2

48-P 10/100/1000 Base-T + 2 10G Combo TP/SFP Layer 2+ Full Management Switch

NGSME48T4HX

48-P 10/100/1000 Base-T + 4 10G Combo TP/SFP Layer 2/3 + PoE+ Switch(2*920 W) Dual Power

GBIC/Media Converters:-

- Fiber-to-copper and copper-to-fiber data conversion.
- Designed to translate and transmit the data between two dissimilar transmission media, such as copper cables and optical fibers.



NVSM550U

1-P 1000Base-SX Mini-GBIC Module(SM,SFP)

NGS16MCRS

16-slot Media Converter Chassis for Redundant Power Supply

Wireless and Controllers:-

- The Niveo Professional WAC series consist of a Niveo NWAC7000 Wireless AP access controller and up to 300 Niveo Wireless Access Points(both NWA300 and NWA220), providing centralized deployment.
- Automatically detecting and management of wireless APs.
- More power and Beamforming technology for more range and stable signal, RF power adjustment and frequency analyzer.



NRS-RC1

4-Port Smart router/Controller PoE+ Gigabit Switch. The NRS-RC1 is a Smart Router and CAPWAP Protocol WLAN controller and (PoE) Ethernet switch. All in one!



NWA300

11ac 1200Mbps Manageable PoE Ceiling Wireless AP



NWAC64

Enterprise Gateway & WLAN Controller

► Quality

Authorized Distributor, 100% Genuine products with proper clearance and invoice, delivered to your door.

► Service

Product training, Pre and Post sales assistance, In-house Tech team, Ready Stock.

► Reliability

Technology acclaimed American and European Brands with international warranty as high as 5-10 years

Why QTECH?

► Design

Trouble designing for the project?, share us the details and we will design it for you.

► Price

Products that are economical but yet high on Innovation, Simplified Technology, having brilliant performance and yet value for money.

Thank You!